

2007  
**Passport**  
ULTRALITE

**Passport**  
ULTRALITE

go anywhere



# Passport

## ULTRALITE

go anywhere

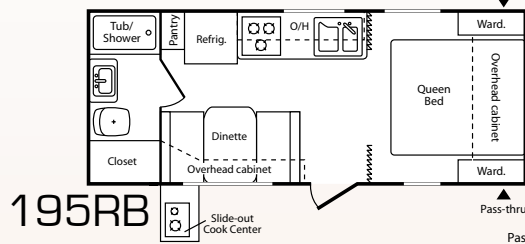
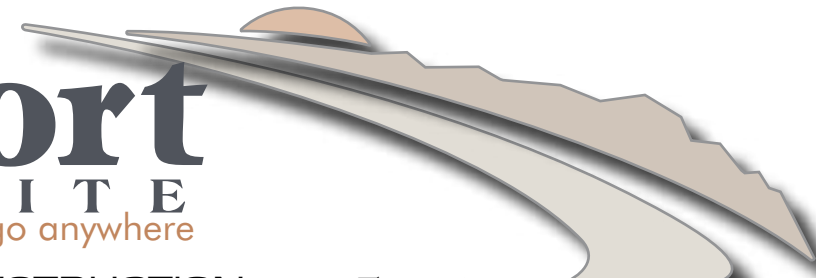

195RB

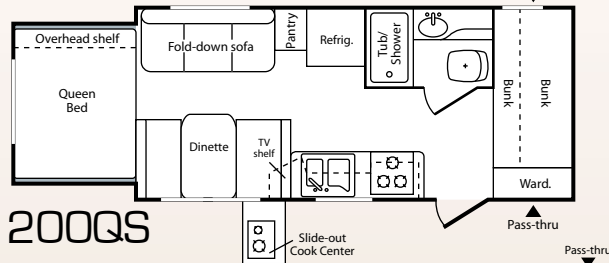

200QS

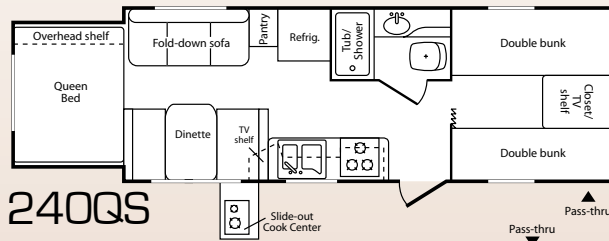

240QS

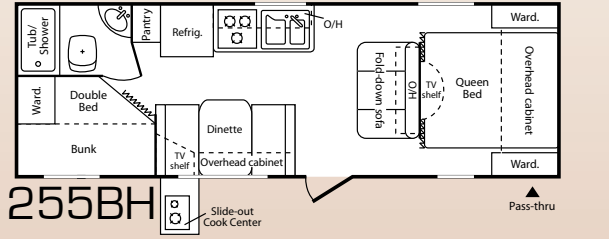

255BH

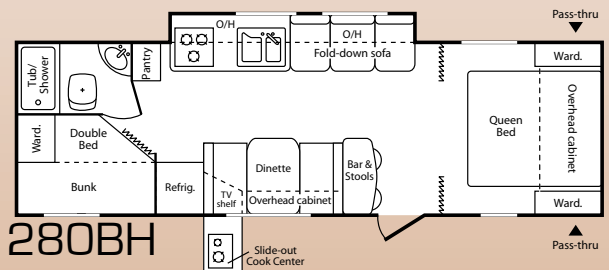

280BH

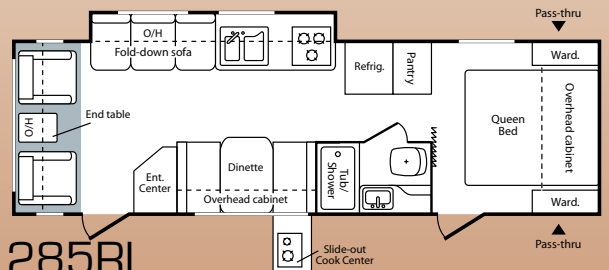

285RL

### APPLIANCES/ EQUIPMENT

- Double Door Refrigerator
- Power Range Hood w/ Light
- Six Gallon Gas/Electric Water Heater w/ DSI
- High Capacity Furnace w/Elec. Ignition
- 13.5 BTU Air Conditioner, Ducted
- Double Bowl Kitchen Sink
- Demand Water Pump
- Copper LP Gas Lines
- Water Heater Bypass Kit
- AM/FM CD Player
- Microwave
- Monitor Panel
- Oven w/3-Burner Range Top
- Cable Hook Up

### BATH

- Shower Curtain
- Power Roof Vent
- Adjustable Shower Head
- Residential Style Sink and Faucet
- Medicine Cabinet
- Wall Mounted Light Switch
- Foot Flush Toilet
- Skylight in Bath
- Tub Surround

### CONSTRUCTION

- Welded, Aluminum Frame, Laminated Walls with Polystyrene Block Foam Insulation
- 5" Galvanized Steel Crowned Rafters
- ABS Holding Tanks
- Roto-cast Fresh Water Tank
- Enclosed Underbelly

### ELECTRICAL

- Patio Light
- Ceiling Lights
- 120 Volt GFI Protected Circuits
- 55 Amp Converter w/Charger
- 30 Amp Power Cord
- Dual Battery Rack

### EXTERIOR

- Rubber Roof
- Gel-coat Fiberglass Skin
- "E" Coated Chassis
- Tinted Safety Glass Windows
- Radius Entry Door w/ Window, Dead-bolt Lock and Screen Door
- Outside Storage Compartment
- Self-Storing Step
- 2 - 5/16" Coupler
- Radius Baggage Door
- Exterior Shower
- TV Antenna with Booster
- 4 Stabilizer Jacks

- Patio Awning
- Spare Tire Kit
- Outside Speakers

### INTERIOR

- Large Galley Window
- Hard Valances in Living Room
- Mini Blinds
- No-Wax Flooring
- Raised Panel Cabinet Doors

### RUNNING GEAR

- 14" Radial Trailer Tires
- Load Equalization Axle System
- 10" Electric Brakes, All Wheels
- Galvanized Wheel Wells
- Leaf Spring Suspension System

### SAFETY

- Break-A-Way Switch
- Fire Extinguisher
- Smoke Detector
- LP Detector
- Heavy Duty Safety Chains
- Carbon Monoxide Detector

### OPTIONS

- Exterior Slide Out Cook Center

	195RB	200QS	240QS	255BH	280BH	285RL
Shipping Weight	TBD	TBD	TBD	TBD	4580	4820
Carrying Capacity	TBD	TBD	TBD	TBD	1460	1430
Hitch	TBD	TBD	TBD	TBD	440	650
Exterior Length	23'10"	22'1"	26'1"	28'5"	31' 1"	31'1"
Ext Height	TBD	TBD	TBD	TBD	10' 3"	10'3"
Fresh Water gal.	30	30	30	30	30	30
Waste Water gal.	30	30	30	30	30	30
Grey Water gal.	30	30	30	30	30	30
LPG Capacity lbs.	40	40	40	40	40	40
Tire Size	205/75D14C	205/75D14C	205/75D14C	205/75D14C	205/75D14C	205/75D14C



**Passport**  
ULTRALITE  
IS A PRODUCT OF:

**2642 Hackberry Drive  
Goshen, Indiana 46526  
(574) 535-2100**

Your PASSPORT dealer: [www.keystone-passport.com](http://www.keystone-passport.com)



Product information is as accurate as possible as of the date of publication of this brochure. Features, floor plans, and specifications are subject to change without notice. Please also consult Keystone's web site at [www.keystonerv.com](http://www.keystonerv.com) for more current product information and specifications. Tow Vehicle disclaimer: CAUTION: Owners of Keystone recreational vehicles are solely responsible for the selection and proper use of tow vehicles. All customers should consult with a motor vehicle manufacturer or their dealer concerning the purchase and use of suitable tow vehicles for Keystone products. Keystone disclaims any liability or damages suffered as a result of the selection, operation, use or misuse of a tow vehicle. KEYSTONE'S LIMITED WARRANTY DOES NOT COVER DAMAGE TO THE RECREATIONAL VEHICLE OR THE TOW VEHICLE AS A RESULT OF THE SELECTION, OPERATION, USE OR MISUSE OF THE TOW VEHICLE. November 2006.